

Burners

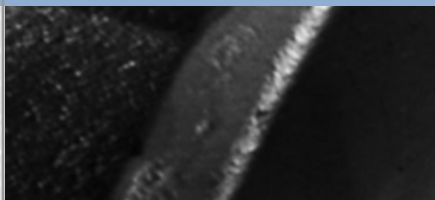

Blast pilots

PBC & PBST (E3280 rev. 01 - 08/01/2010)



GENERAL WARNINGS:



■ All installation, maintenance, ignition and setting must be performed by qualified staff, respecting the norms present at the time and place of the installation.

■ To avoid damage to people and things, it is essential to observe all the points indicated in this handbook. The reported indications do not exonerate the Client/User from observing general or specific laws concerning accidents and environmental safeguarding.

■ The operator must wear proper DPI clothing (shoes, helmets...) and respect the general safety, prevention and precaution norms.

■ To avoid the risks of burns or high voltage electrocution, the operator must avoid all contact with the burner and its control devices during the ignition phase and while it is running at high temperatures.

■ All ordinary and extraordinary maintenance must be performed when the system is stopped.

■ To assure correct and safe use of the combustion plant, it is of extreme importance that the contents of this document be brought to the attention of and be meticulously observed by all personnel in charge of controlling and working the devices.

■ The functioning of a combustion plant can be dangerous and cause injuries to persons or damage to equipment. Every burner must be provided with certified combustion safety and supervision devices.

■ The burner must be installed correctly to prevent any type of accidental/undesired heat transmission from the flame to the operator or the equipment.

■ The performances indicated in this technical document regarding the range of products are a result of experimental tests carried out at ESA-PYRONICS. The tests have been performed using ignition systems, flame detectors and supervisors developed by ESA-PYRONICS. The respect of the above mentioned functioning conditions cannot be guaranteed if equipment, which is not present in the ESA-PYRONICS catalogue, is used.

DISPOSAL:



To dispose of the product, abide by the local legislations regarding it.

GENERAL NOTES:



■ In accordance to the internal policy of constant quality improvement, ESA-PYRONICS reserves the right to modify the technical characteristics of the present document at any time and without warning.

■ It is possible to download technical sheets which have been updated to the latest revision from the **www.esapyronics.com** website.

CERTIFICATIONS:



EN746-2

The products manufactured by ESA-PYRONICS have been created in conformity to the **UNI EN 746-2** Norms: Equipment for industrial thermal process - Part 2: Safety requirements for combustion and the movement and treatment of combustible elements. This norm is in harmony with the Machine Directive **98/37/CE**. It is certified that the products in question respect all the requirements prescribed by the above mentioned Norms and Directives. These have been designed, produced, controlled and tested in accordance to the company's internal procedures for quality control, certified in conformity with the **UNI EN ISO 9001** Norm by DNV Italia s.r.l.



The products conform to the Russian market requirements according to the **GOST** and **GOSGORTEKHNAZDOR** certification.

CONTACTS / SERVICE:



Headquarters:

Esa s.r.l.
Via Enrico Fermi 40
24035 Curno (BG) - Italy
Tel +39.035.6227411
Fax +39.035.6227499
esa@esacombustion.it

International Sales:

Pyronics International s.a.
Zoning Industriel, 4ème rue
B-6040 Jumet - Belgium
Tel +32.71.256970
Fax +32.71.256979
marketing@pyronics.be

www.esapyronics.com

The PBC & PBST series identifies a range of premix burners that are mainly used as pilot flames to ignite burners with larger capacities. The particular conformation of the combustion head guarantees excellent flame retention, high resistance to temperature changes and long life.

APPLICATIONS

- Main burner blast pilot.
- Billet heating.
- Glass furnaces.
- Bunsen burner casting.



F3280I03

CHARACTERISTICS

GENERAL:

- | | |
|-------------------------------|------------------------------|
| ■ Capacity: | from 2 to 15 kW |
| ■ Combustion gas: | CH ₄ /GPL/Propane |
| ■ Ignition/Detection: | monoelectrode |
| ■ Max. temperature used: | 1100°C |
| ■ Excellent flame stability | |
| ■ Maximum air inlet pressure: | 360 mbar |
| ■ Maximum gas inlet pressure: | 100 mbar |

MATERIAL COMPOSITION:

- | | |
|--------------------|-----------------------------|
| ■ Combustion head: | AISI310/Aluminium oxide 96% |
| ■ Flame tube: | AISI304/INCOLOY 601 |



F3280I04

CAPACITY PARAMETERS

Coupled with MM or FLOWMIXER mixers, the PBC & PBST burners develop maximum flame capacity at roughly 15 mbar premix pressure.

The burners remain stable with mixed pressures between 10 and 20mbar.

Model	Max capacity [kW]	Flame length [mm]	Ignition/Detection electrode
P42PBC	2	30÷40	42CWFR & 42CWFR/X
P64PBC	5	50÷70	64CWFR & 64CWFR/X
P86PBC	10	80÷100	86CWFR & 86CWFR/X
P64PBST	5	50÷70	10MM
P86PBST	10	80÷100	10MM
P108PBST	15	100÷120	6EN/10MM

FLOW SCHEME - CERAMIC BLAST PILOTS

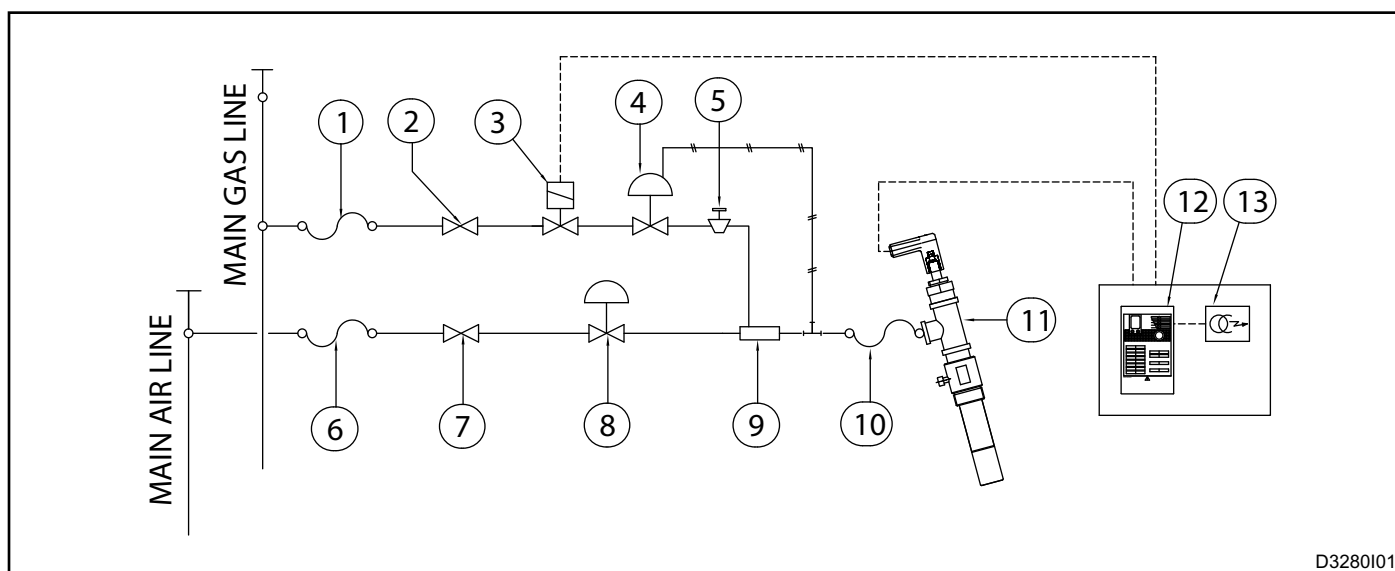

D3280I01

Pos.	Description	Included	Not Included
1	Gas flexible hose (*)		x
2	Gas interception valve	x	
3	Solenoid safety valve (**)		x
4	Zerogovernor	x	
5	Micrometric regulation screw	x	
6	Flexible air hose (*)		x
7	Air interception valve	x	
8	Pressure stabilizer	x	
9	Venturi mixer	x	
10	Extensible flexible hose	x	
11	Pilot burner	x	
12	Flame control		x
13	Ignition transformer		x

(*) Client's responsibility

(**) Optional

WARNINGS

- - For all applications at low temperatures (up to 750°C), the burner ignition and the gas fuel solenoid valve command must be carried out using a certified burner control device.
- - To avoid any possible damage to the burners, make sure that the air is not preheated or foul due to combustion products, oils, solvents or other. To avoid these phenomena, it is preferable to install the blower or suction duct outside the premises and far from exhaust pipes, or else to fit filters upstream the premix group. If the atomizing air should come from the compressed air lines, NEVER exceed the maximum allowable pressure $P_{max}=360$ [mm].
- - After installation, check that the power feeding lines are connected correctly. Before switching the burner on check that the combustion air and fuel pressure values are correct.
- - The burner must only function within the indicated power ranges. Working with lower or higher power may compromise the functioning and life span of the burner, in which case the general guarantee conditions will automatically expire and ESA-PYRONICS will not be held liable for possible damage caused to persons and objects.
- - Should there be disturbances with other devices during the burner start-up phase, use an anti-disturbance filter for the high voltage cable (hv) connection to the ignition electrode.
- - Avoid burner ignition close to each other so as not to heat the ignition command system devices (solenoid valves and transformers). Prewash time lapse + first safety time lapse + min. of 5 sec. = time lapse between one ignition and another. (However, do not attempt more than 2 ignitions during a 30sec. time lapse).
- - Make sure the power supply is TURNED OFF when intervening on the burner and its devices. In case of burner malfunctioning, follow the indications in the 'Maintenance' chapter of the present manual or contact ESA-PYRONICS assistance.
- - Any modification or repair done by third parties can compromise the application safety and automatically cause the general warranty conditions to expire. Contact ESA-PYRONICS assistance.

INSTALLATION

The PBC & PBST series pilot burners are supplied with threaded fastening connectors. It is possible to create fastening applications according to specific needs. To avoid foreign material from obstructing the burner flame tube and condensation phenomena causing ignition and detection problems, we do not recommend assembling with the flame pointing upwards. For the mixing pipe connection, the use of flexible extensible connectors is advisable: the connections between the burner and mixer

must have at least the same outlet diameter as the mixer. Do not place valves nor any type of restrictions on the mixture pipeline. For the PBC/X & PBST/X models with variable lengths and sliding fixing couplings, check that the pilot burner outlet is not placed in direct contact with the main burner flame. This is important to preserve the integrity of the metallic pipe.

IGNITION - SETTING

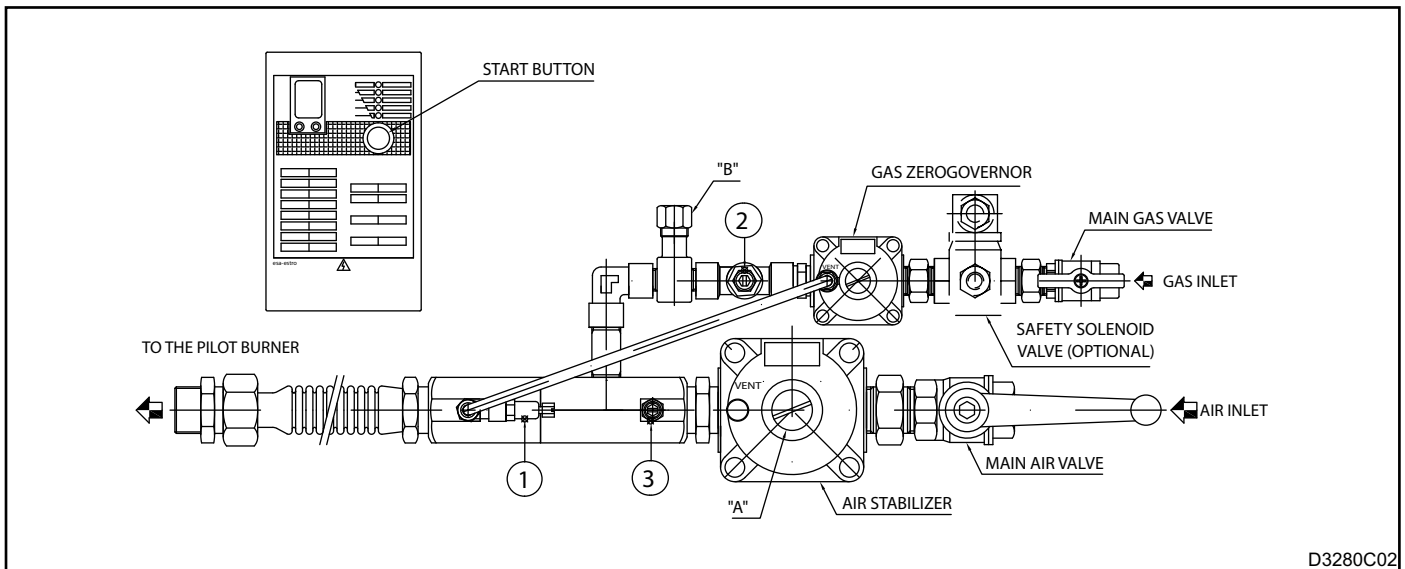

D3280C02

The procedures indicated in the following chapter must be carried out by expert technicians. The non-observance of the instructions given can provoke dangerous conditions.

- 1 - Check the safety solenoid valve (if present), ignition electrode and flame control electrical connections.
- 2 - Check for an air minimum feeding pressure of 36mbar and a gas minimum feeding pressure 20mbar.
- 3 - Open the main air valve.
- 4 - Open the air stabilizer cap ("A").
- 5 - Adjust the spring regulation (screwing on or unscrewing the regulation plug) until reaching a mix-pressure of 10÷15 mbar on the pressure plug (**pos. 01**) with "burner OFF". Screwing on increases the pressure/unscrewing decreases the pressure.
- 6 - The gas pressure with burner off (**pos.02**) must be negative. The air inlet pressure (**pos.03**) must be 40÷50 mbar.
- 7 - Open the main gas valve.
- 8 - Switch the burner on with the start button found on the flame control device, opening the gas throttle valve nee-

dle ("B") very slowly, during ignition (repeat the step until you see a stable flame on the pilot burner).

9 - Adjust the gas flow via the gas throttle valve screw cap to reach the highest detection value on the flame control.

10 - To obtain an excellent flame, adjust the gas flow in the following conditions:

A - Excess of air: short blue flame that disappears into the pilot tube (low detection).

B - Right ratio: light blue tense flame with a good detection (40÷60 μA).

C - Excess of gas: long blue-green flame near flame detachment (low detection).

11 - Once the right regulation has been reached, check for a mix-pressure of 15÷20 mbar (**pos.01**) with "burner on". Adjust the air stabilizer screw if necessary.

12 - Turn off the burner and make sure it starts again, checking for several positive ignitions.

13 - Make sure there is pressure downstream the zero-governor (**pos.02**). The right value is similar to the mix-pressure value that is set in the air regulation (it can be adjusted by adjusting the zero-governor spring position).



F3280I05

Excess of air



F3280I06

Right ratio



F3280I07

Excess of gas

CAPACITY DIAGRAM

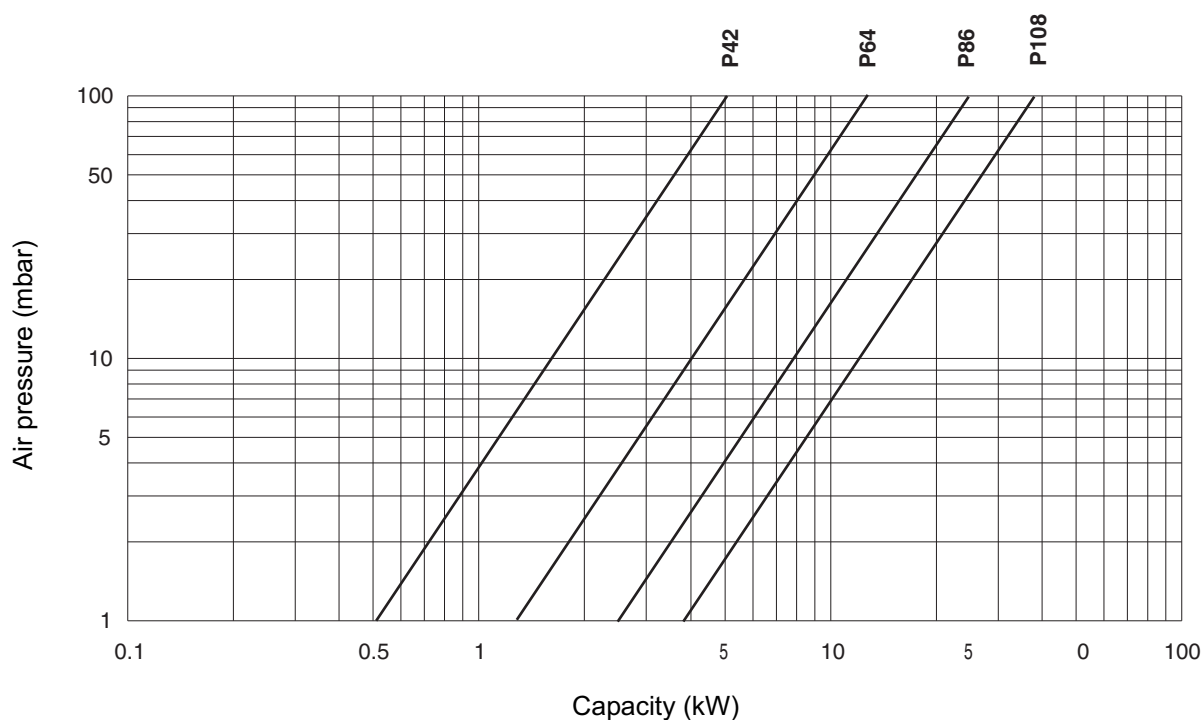

G3280C01

GENERAL MAINTENANCE PLAN

Operation	Type	Advised time	Notes
High voltage electrode connection	O	annual	Check integrity of outer plastic and oxidation of internal connector and of the electrode terminal
Ignition electrode and nozzle	O	annual	Replace if the Kantal terminal is worn or if the ceramic is damaged.
Stainless steel flexible hose	E	every six months	Check that there are no possible mixture leaks from the connectors and flexible hose
Burner settings	O	annual	Repeat all the steps in the "IGNITION AND SETTINGS" chapter on pg 9

O= Ordinary
E= Extraordinary

ORDINARY MAINTENANCE - BURNERS PBC & P108PBST-FR/X

IGNITION ELECTRODE REPLACEMENT

- 1 - Check that the burner control device power is off.
- 2 - Disconnect the HV cable, disconnecting the insulating connector from the electrode (**pos. 01**).
- 3 - Unscrew the block screw (**pos. 03**) and extract the pilot burner from the fastening connection (**pos. 04**).
- 4 - Unscrew the upper connection (**pos. 02**) and completely extract the electrode from the pilot burner.
- 5 - Insert the spare electrode and screw on the connection completely.
- 6 - Place the pilot burner in the correct position, tightening the appropriate screw (**pos. 03**).
- 7 - Check that the insulator connector is properly connected.

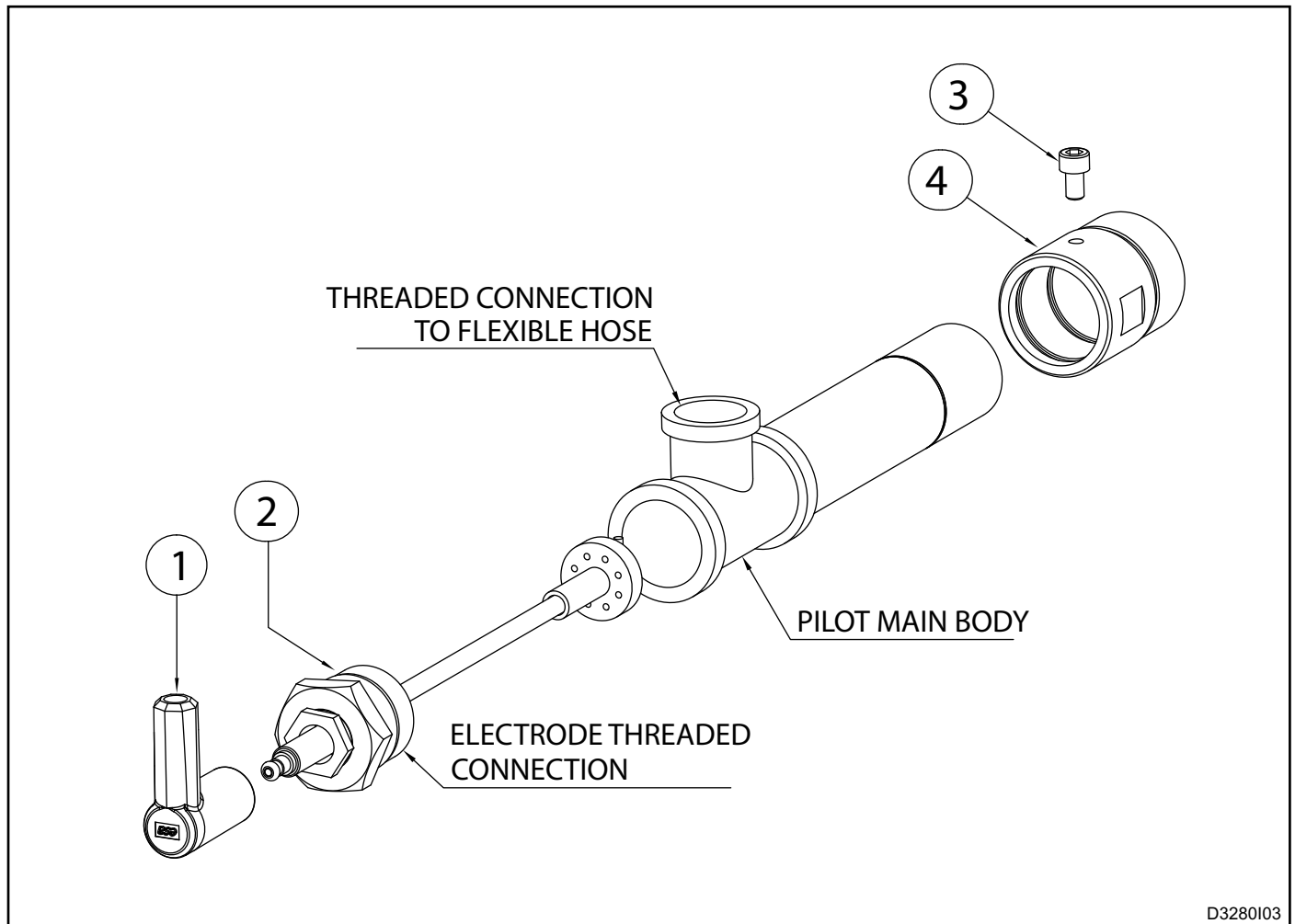

ORDINARY MAINTENANCE - BURNERS PBST

IGNITION ELECTRODE REPLACEMENT

- 1 - Check that the burner control device power is off.
- 2 - Disconnect the HV cable, disconnecting the insulating connector from the electrode (**pos. 01**).
- 3 - Unscrew the spark-plug (**pos. 02**) and extract it from the threaded seat.
- 4 - Insert the new spark-plug rescrewing it on until it clicks into place.
- 5 - Check that the insulator connector is properly connected.

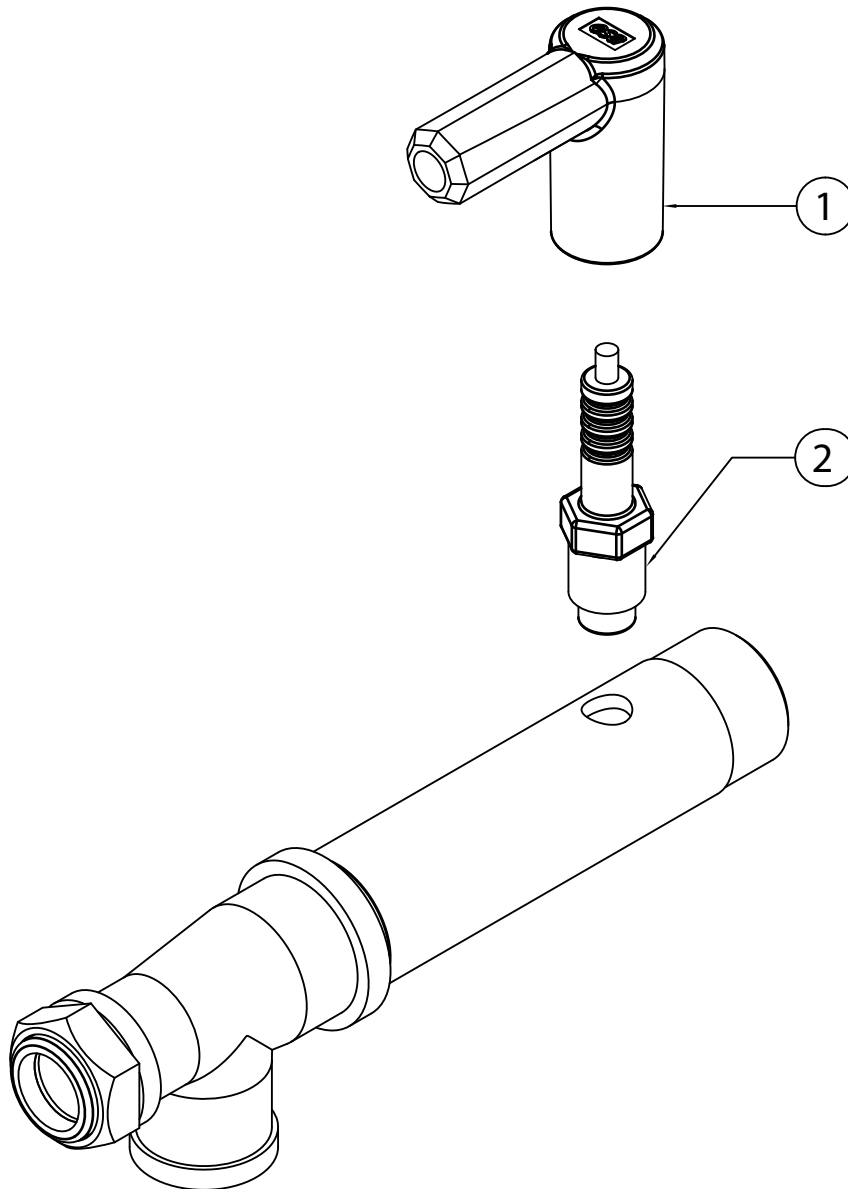

D3280I04

OVERALL DIMENSIONS - P42PBC-FR/X

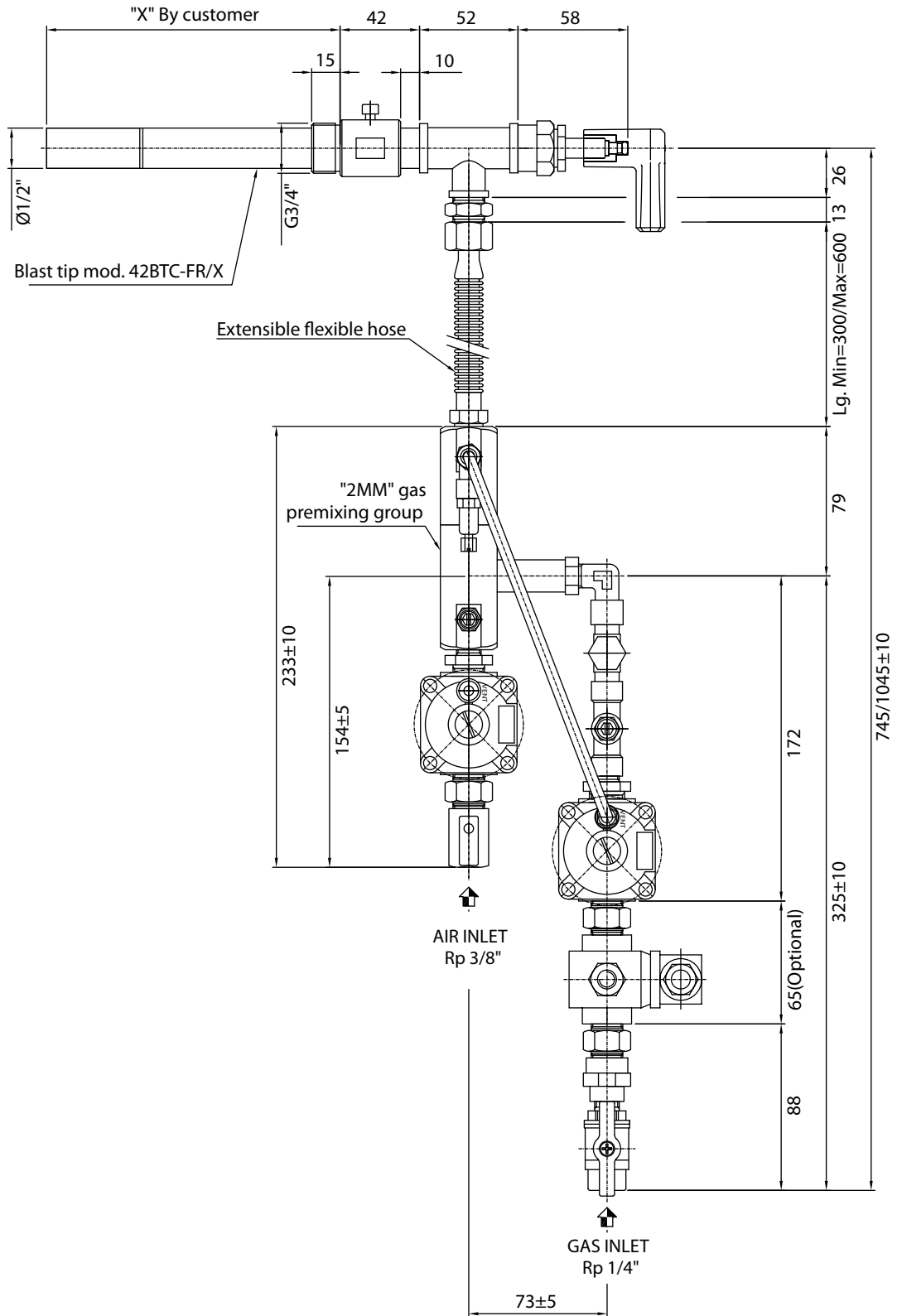

D3280I05

OVERALL DIMENSIONS - P64PBC-FR/X

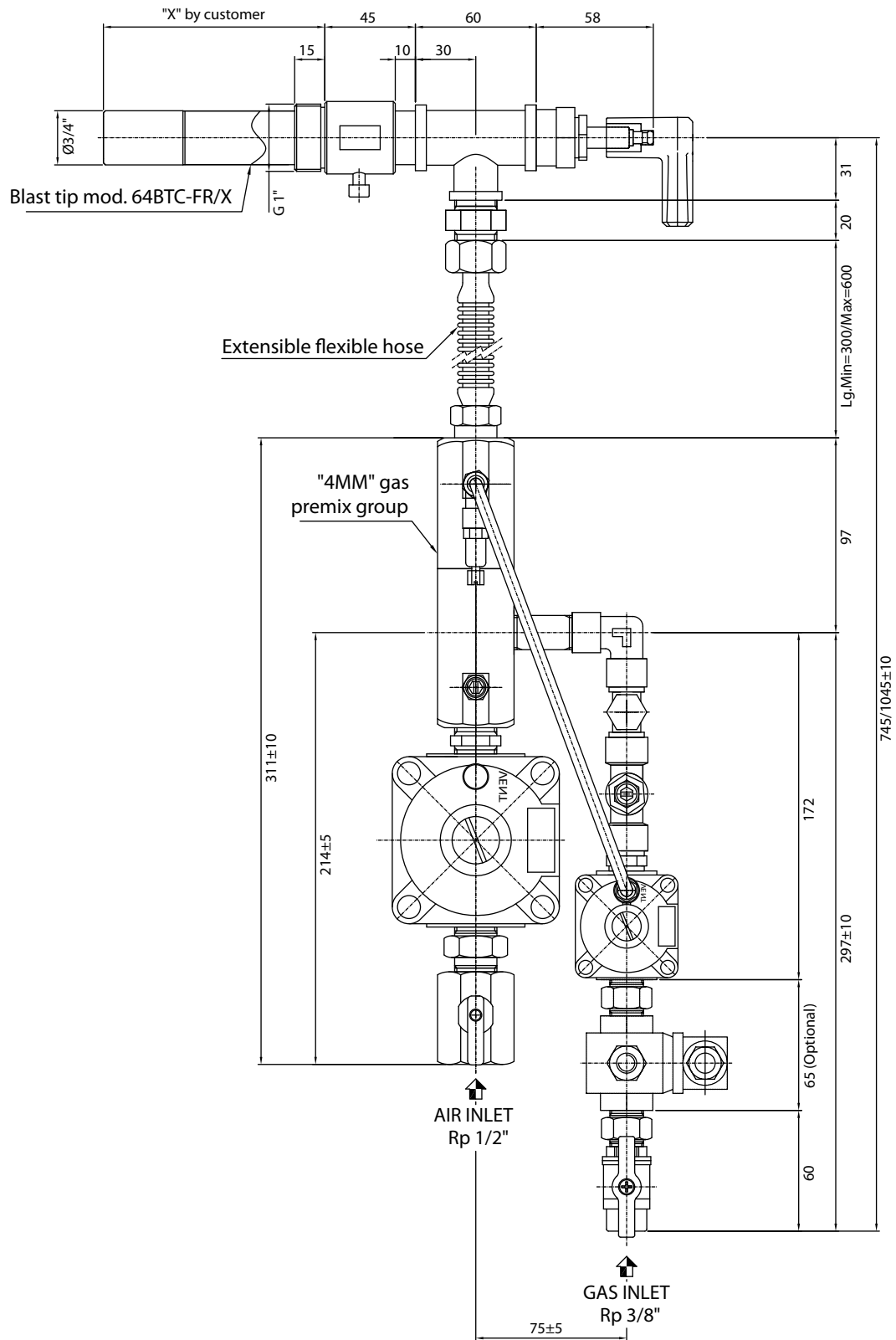

D3280106

OVERALL DIMENSIONS - P86PBC-FR/X

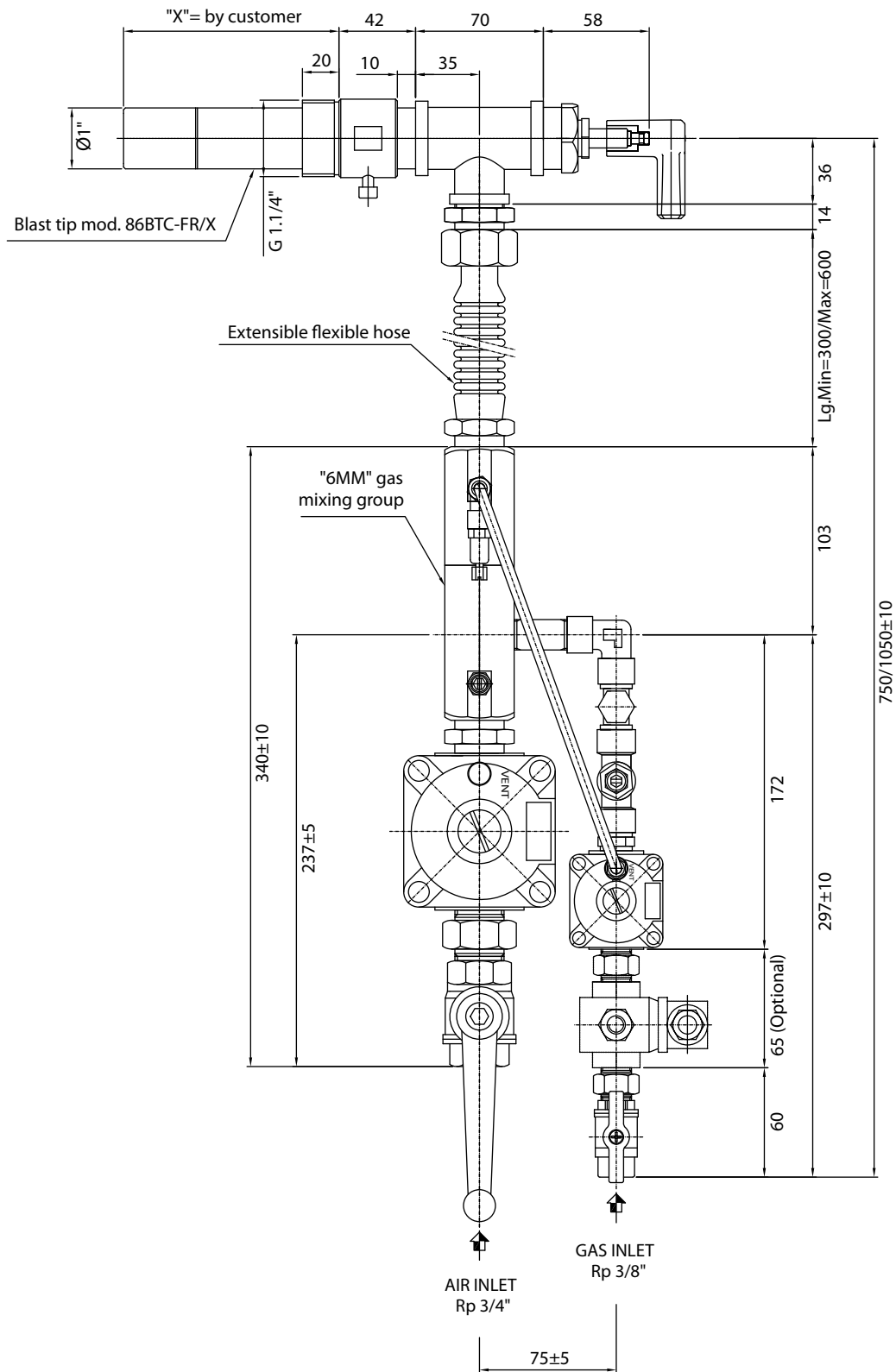

D3280I07

OVERALL DIMENSIONS - P108PBST-FR/X

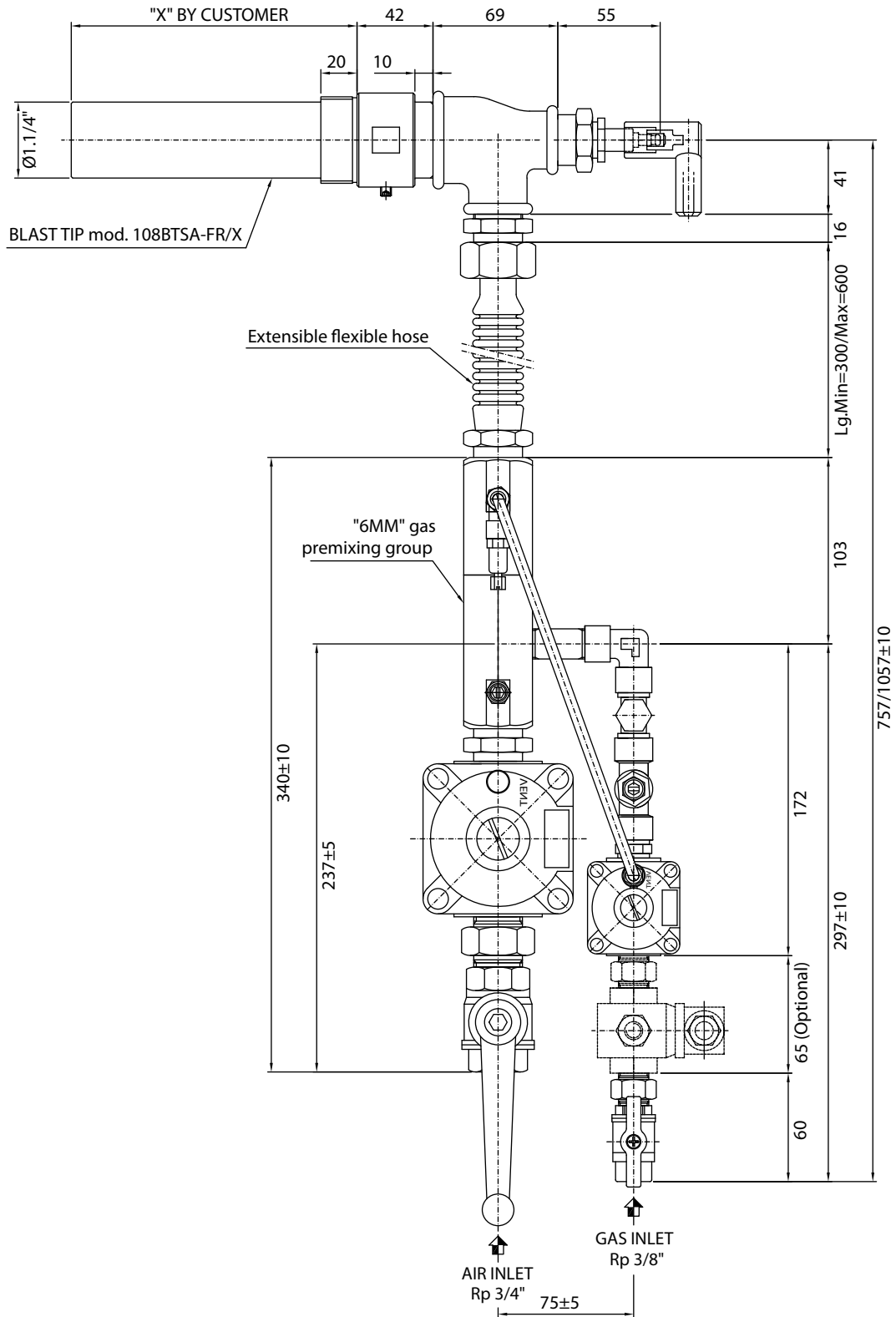

D3280108

OVERALL DIMENSIONS - P42PBC-FR

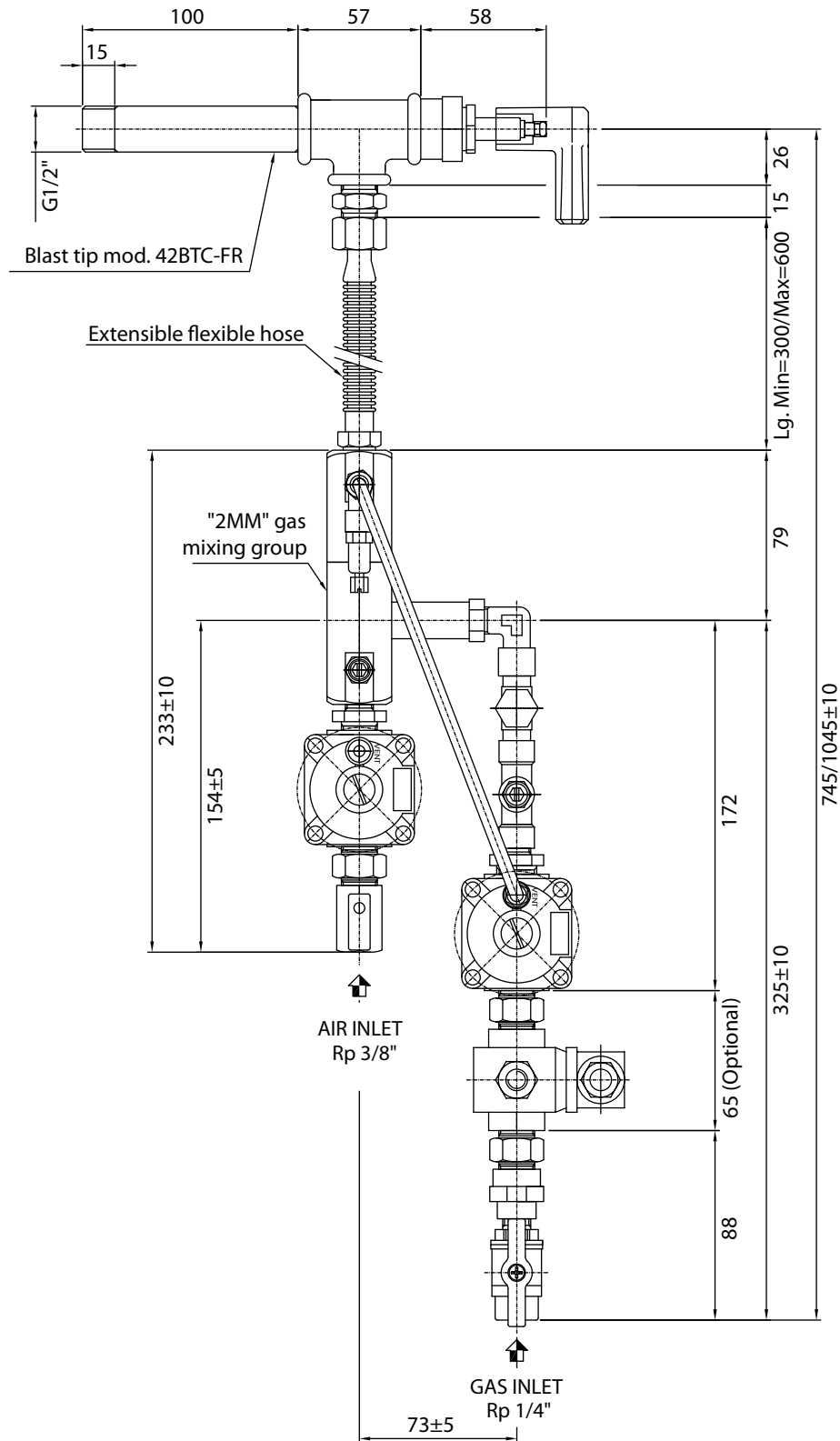

D3280109

OVERALL DIMENSIONS - P64PBC-FR

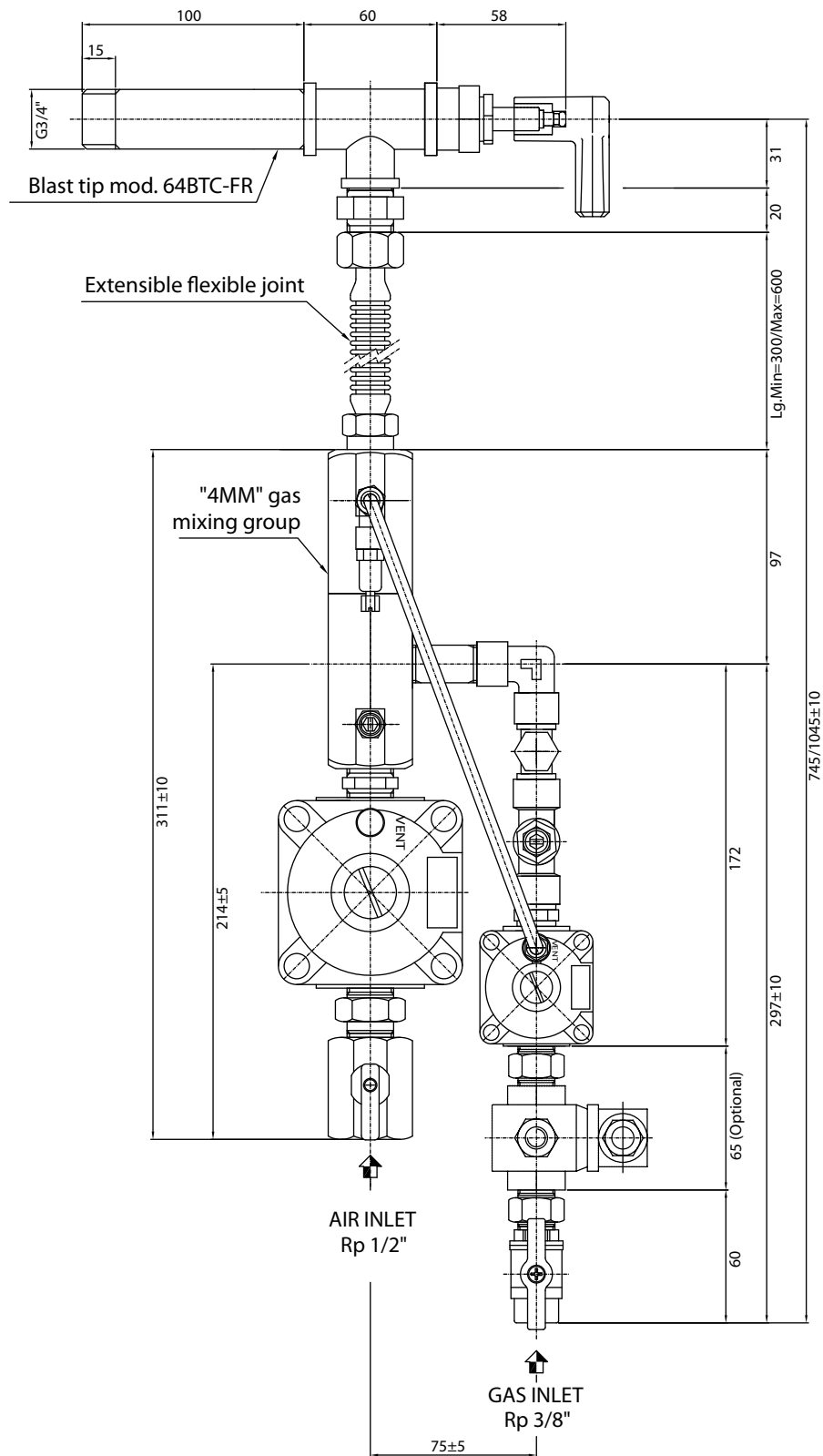

D3280110

OVERALL DIMENSIONS - P86PBC-FR

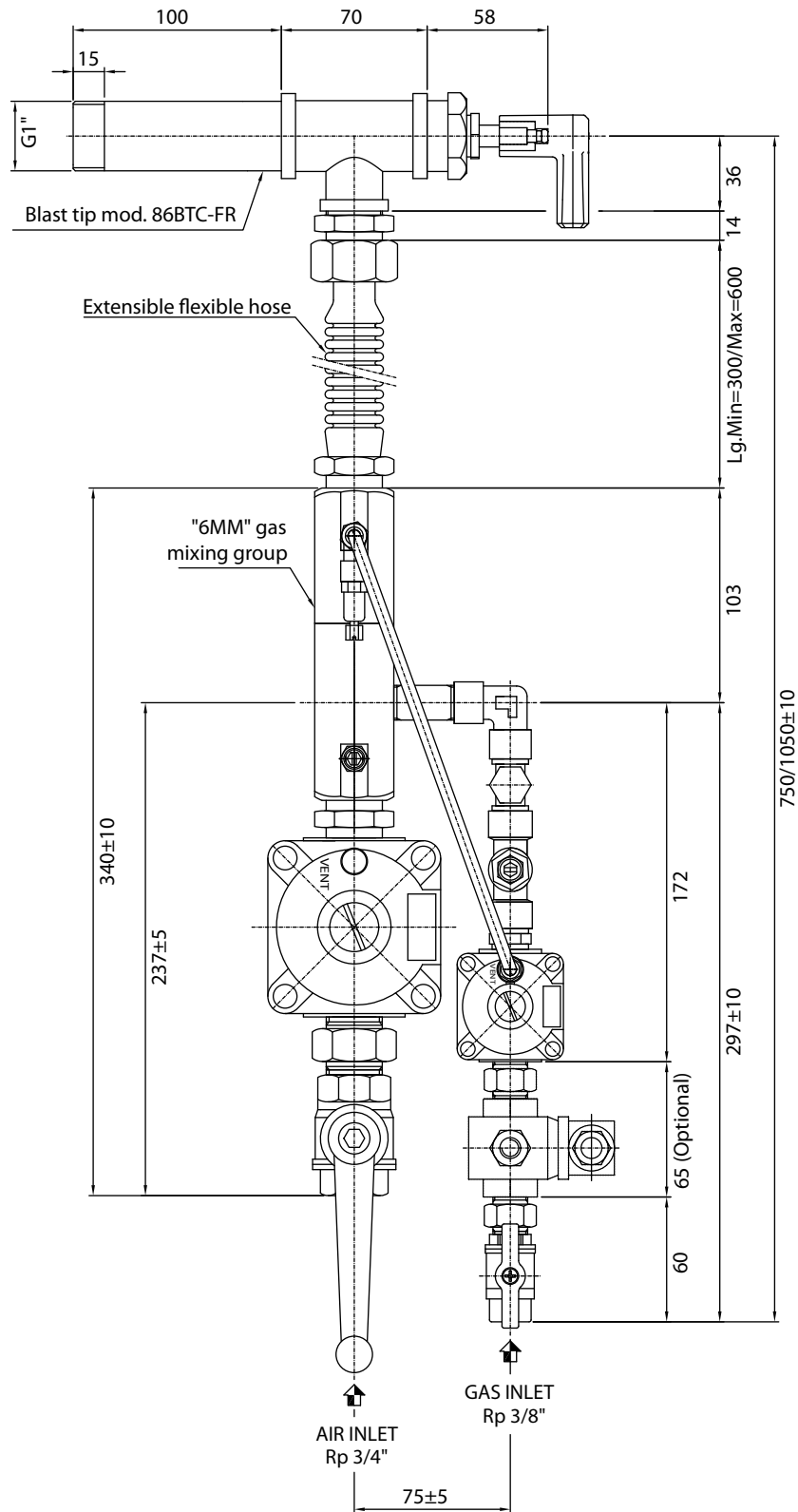

D3280I11

OVERALL DIMENSIONS - P108PBST-FR

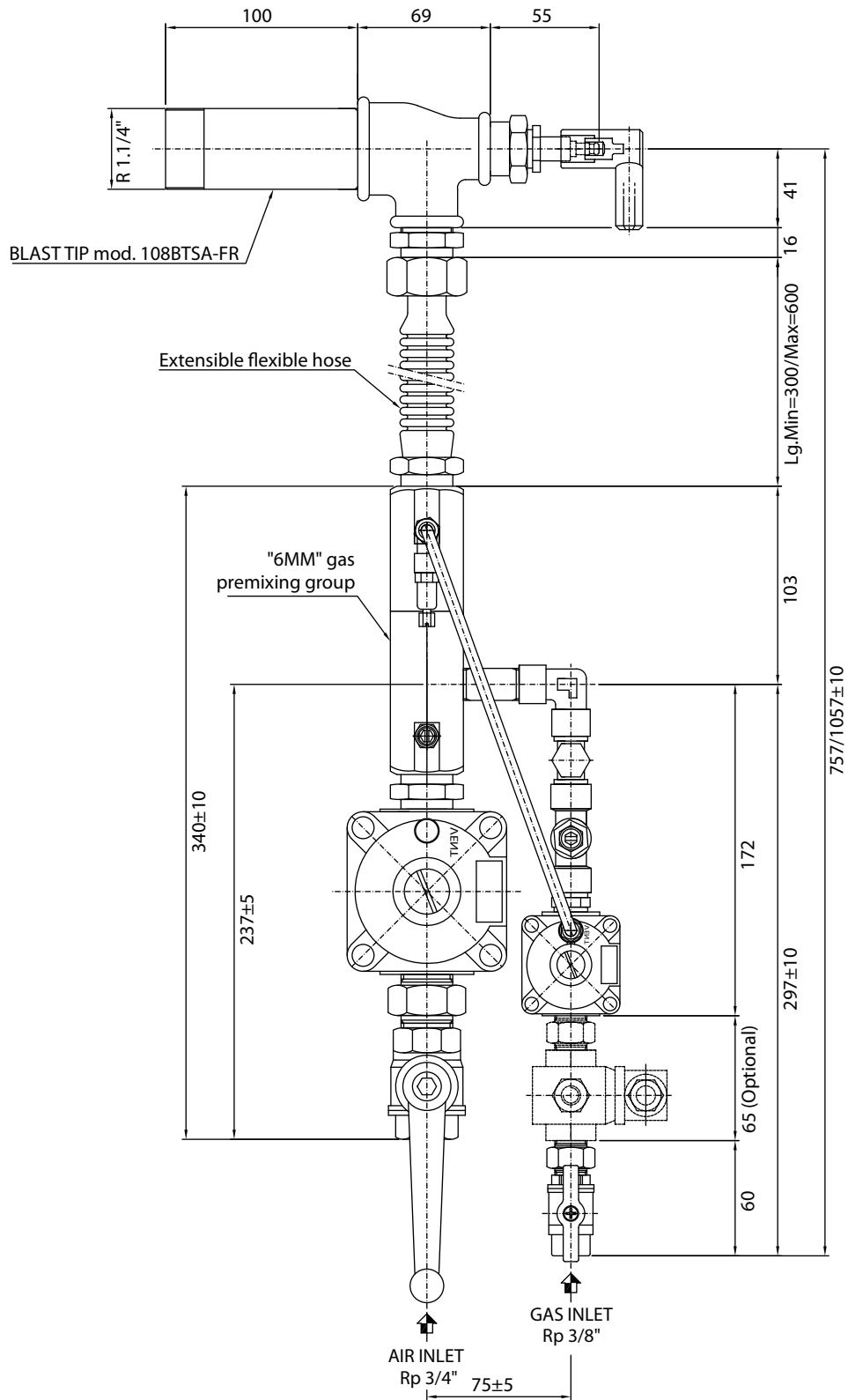

D3280I12

OVERALL DIMENSIONS - P64PBST

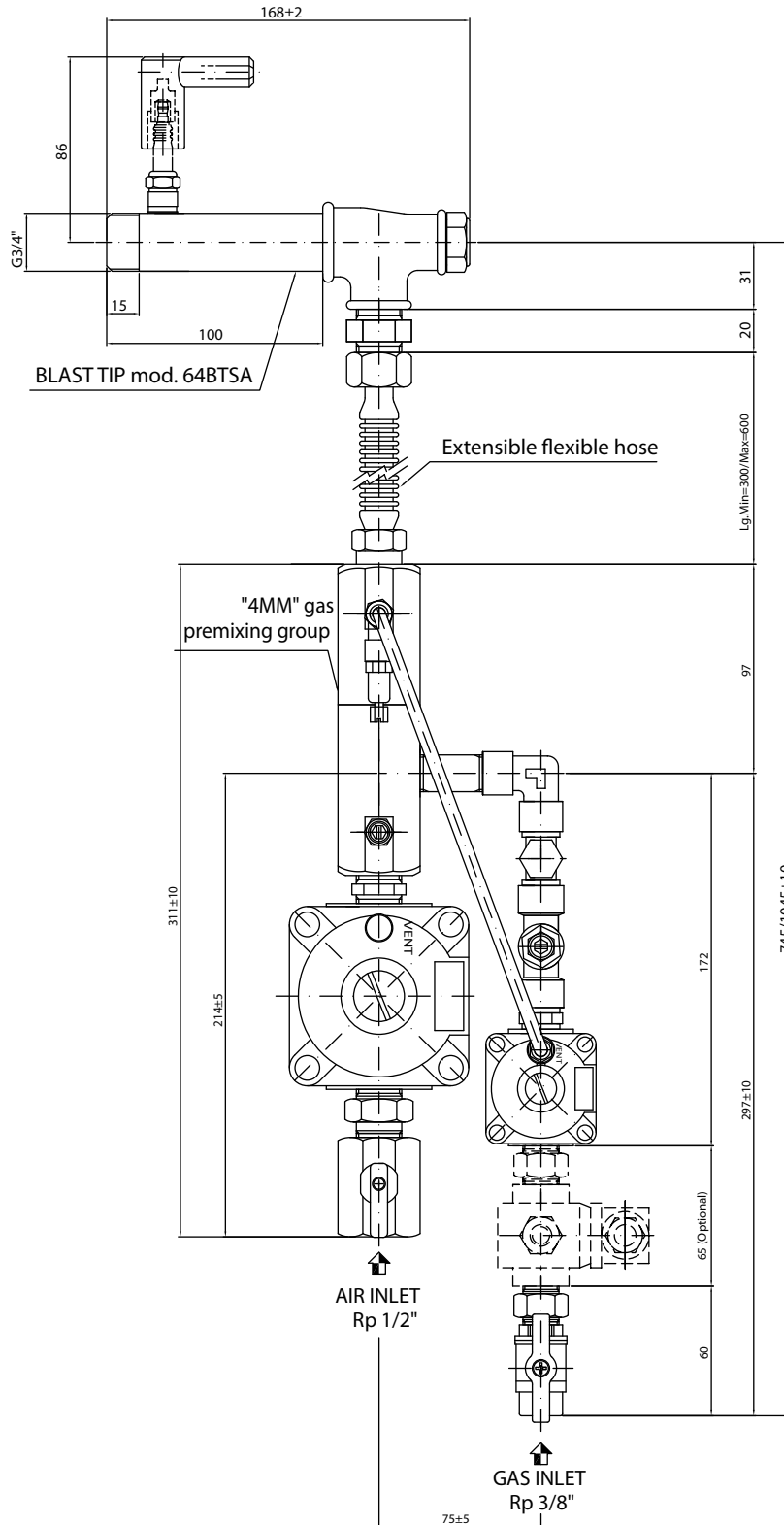

D3280I13

OVERALL DIMENSIONS - P86PBST

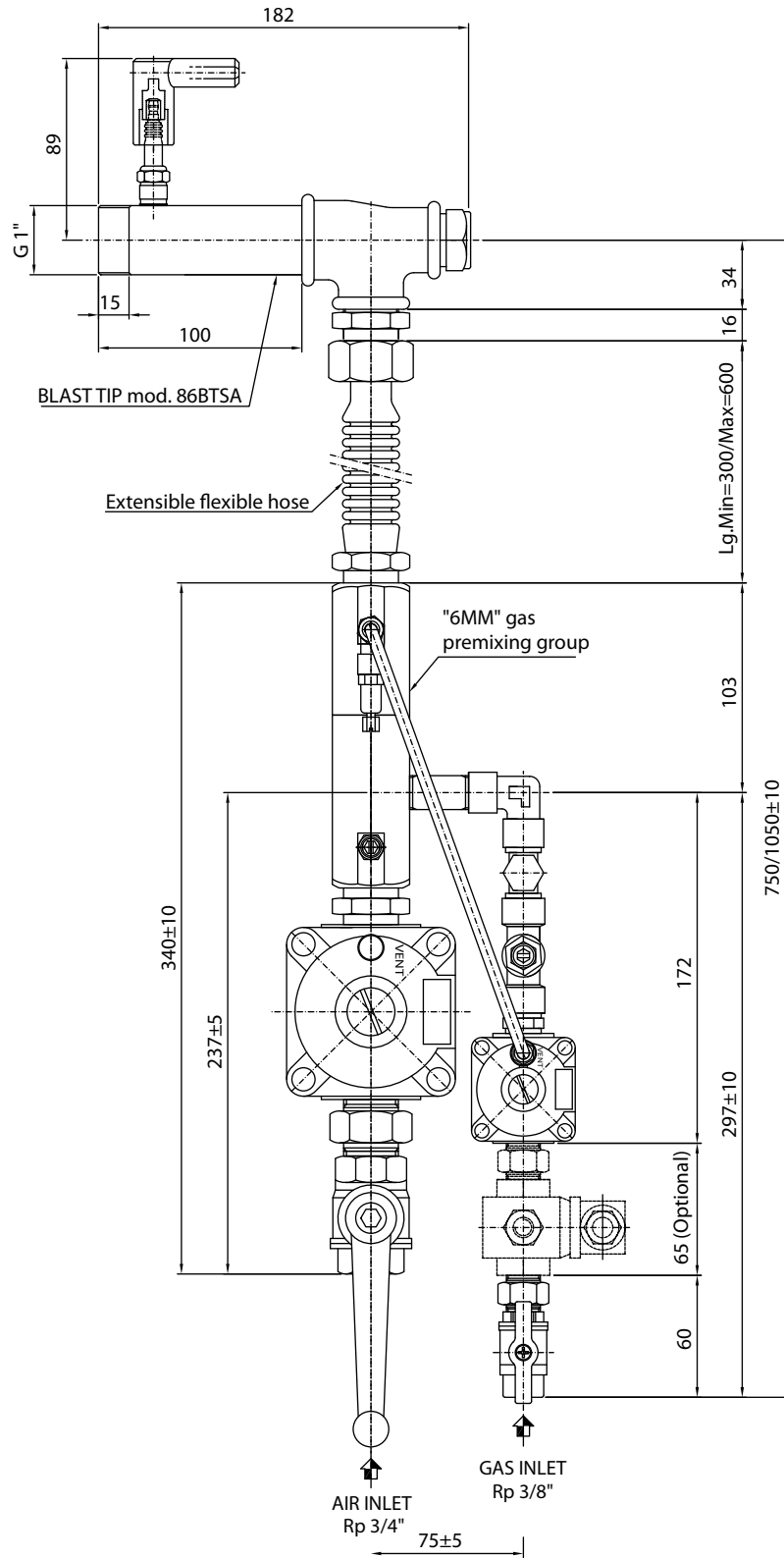

D3280I14

OVERALL DIMENSIONS - P108PBST

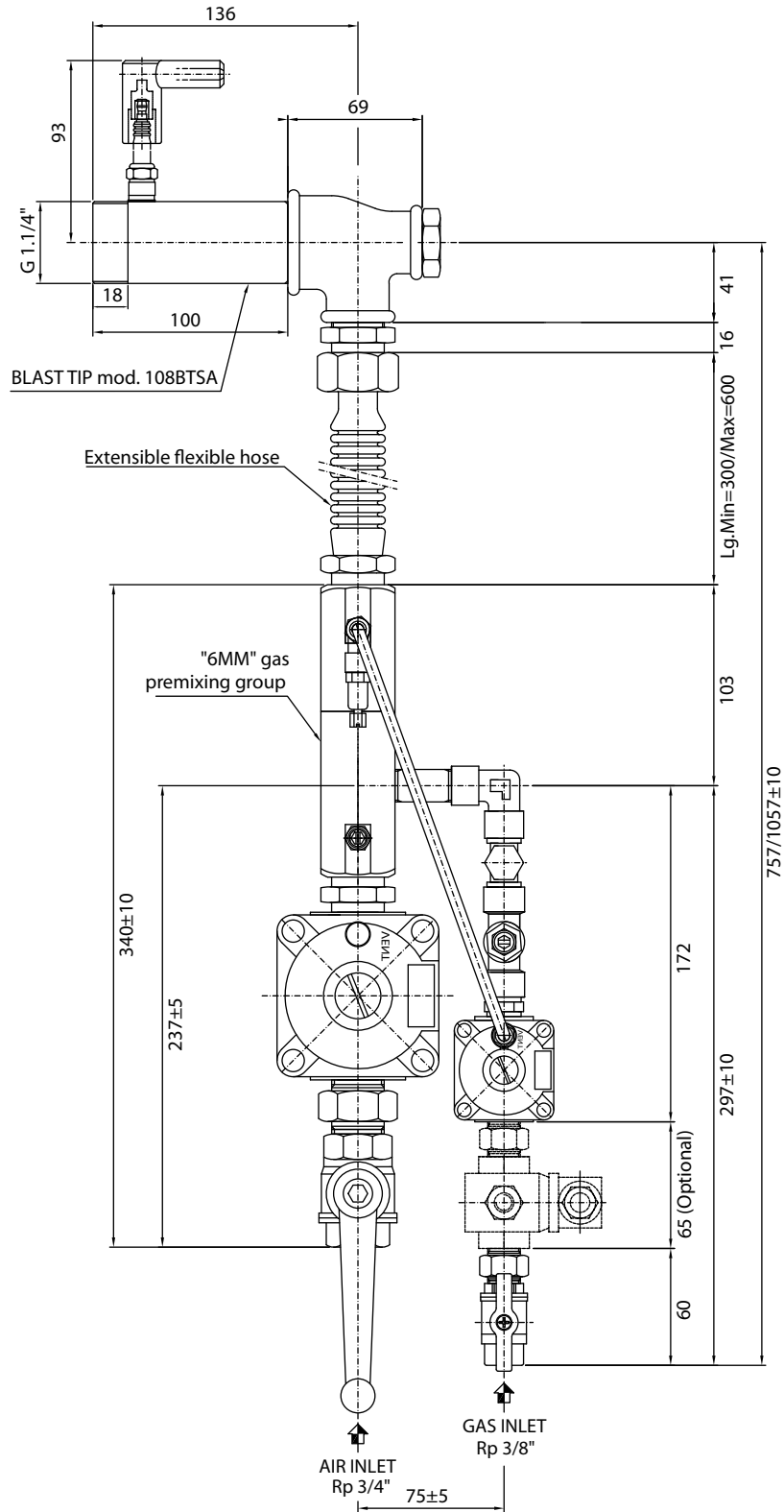

D3280I15